

SELF-CLINCHING STANDOFFS -- 303 STAINLESS STEEL

Body Code & Thread Size	S		H		Hole Size in Sheet		Distance from center line of hole to edge of sheet	Min. Sheet Thickness	Performance in .060 in. thick 5052 Aluminum					
	Shank Outside Diameter		Hex Head Dimension		Max	Min			Installation Force	Pushout	Torque Out	Axial Pull Through	Recommended Tightening Torque for Mating Screw (In. Lbs.)	
	Max	Min	Max	Min										Min
4-40	.165	.160	.192	.182	.169	.166	.234	.040	1075	155	10	220	3.8	
6 4-40	.212	.207	.192	.182	.216	.213	.266	.040	1680	290	24	235	3.8	
6-32	.212	.207	.255	.245	.216	.213	.266	.040	1680	290	24	235	7	
8 6-32	.280	.275	.317	.307	.284	.281	.312	.050	2350	400	25	248	7	
8-32	.280	.275	.317	.307	.284	.281	.312	.050	2400	400	45	464	14	
10-32	.280	.275	.317	.307	.284	.281	.312	.050	2400	400	45	464	25	
Tolerance on Length							+.002, -.005							

Description	A cylindrical fastener with a low-profile, hexagon-shaped head. The end opposite the head is internally threaded. It is considered a "blind" fastener because it the threaded section does not extend through the entire length of the standoff. Immediately below the head is a slight indentation that extends completely around the item's circumference. This indentation, or groove, provides the clinching action when the part is pressed thru a properly-sized hole in sheet metal.
Applications / Advantages	The standoff becomes permanently set when squeezed into place into a proper size drilled or punched hole. After it is pressed into place, the standoff forms a flush surface with the sheet metal.
Material	303 Stainless Steel, passivated to ASTM A 380 specifications
For use in...	...materials with a hardness of Rockwell B70 or less.
Finish	Stainless self-clinching standoffs usually do not have any additional finish.

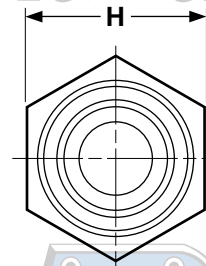
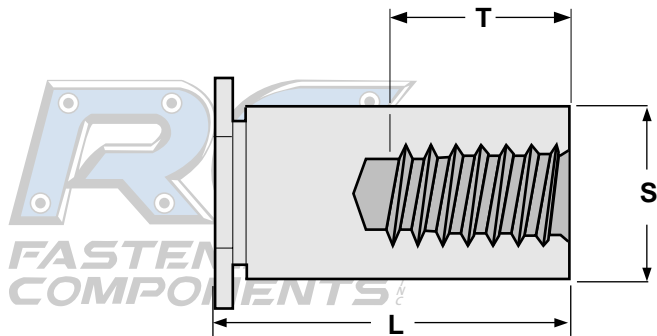

LENGTH OF THREAD FOR SELF-CLINCHING STANDOFFS

Part #	Body Code (if app.) x Thread x Length	T	Part #	Body Code (if app.) x Thread x Length	T	Part #	Body Code (if app.) x Thread x Length	T
		Thread Length			Thread Length			Thread Length
040506SCBSOS	6-4-40 x 5/16	.156	060508SCBSOS	8-6-32 x 5/16	.156	0805SCBSOS	8-32 x 5/16	.156
0405SCBSOS	4-40 x 5/16	.156	0605SCBSOS	6-32 x 5/16	.156	0806SCBSOS	8-32 x 3/8	.156
040606SCBSOS	6-4-40 x 3/8	.156	060608SCBSOS	8-6-32 x 3/8	.156	0807SCBSOS	8-32 x 7/16	.187
0406SCBSOS	4-40 x 3/8	.156	0606SCBSOS	6-32 x 3/8	.156	0808SCBSOS	8-32 x 1/2	.250
040706SCBSOS	6-4-40 x 7/16	.187	060708SCBSOS	8-6-32 x 7/16	.187	0809SCBSOS	8-32 x 9/16	.250
0407SCBSOS	4-40 x 7/16	.187	0607SCBSOS	6-32 x 7/16	.187	0810SCBSOS	8-32 x 5/8	.250
040806SCBSOS	6-4-40 x 1/2	.250	060808SCBSOS	8-6-32 x 1/2	.250	1105SCBSOS	10-32 x 5/16	.156
0408SCBSOS	4-40 x 1/2	.250	0608SCBSOS	6-32 x 1/2	.250	1106SCBSOS	10-32 x 3/8	.156
040906SCBSOS	6-4-40 x 9/16	.250	060908SCBSOS	8-6-32 x 9/16	.250	1107SCBSOS	10-32 x 7/16	.187
0409SCBSOS	4-40 x 9/16	.250	0609SCBSOS	6-32 x 9/16	.250	1108SCBSOS	10-32 x 1/2	.250
041006SCBSOS	6-4-40 x 5/8	.250	061008SCBSOS	8-6-32 x 5/8	.250	1109SCBSOS	10-32 x 9/16	.250
0410SCBSOS	4-40 x 5/8	.250	0610SCBSOS	6-32 x 5/8	.250	1110SCBSOS	10-32 x 5/8	.250

